



TO: All Bourgault Dealers
 ATTN: Service Manager, Parts Manager, Sales Manager
 SUBJECT: 5810 - QDA Style Depth Control Retrofit

CUSTOMER INSTALLED RETROFIT: Effective serial number range – 5810-52’ and 5810-62’

BACKGROUND:

A QDA Style Depth Control Kit has been created for the main frame depth control cylinders on 5810-52/62 units. This QDA style depth control can be used either as a full replacement for the current Quick Shift Depth Control items or used as a “back-up” in conjunction with the Quick Shift Depth Control.

This kit will be considered essential for those who value ease of use, simplicity and for those customers who do not trust the hydraulic depth control components.

This kit is designed to be installed on the two main frame cylinders. These main frame cylinders act as “masters” one controlling the “left” half of the drill and one controlling the “right” half of the drill. Due to the master slave relationship between the main frame and the wing cylinders be aware that internal bypass within the wing cylinders can still result in changes to the desired seeding depth therefore being aware of any internally bypassing cylinders is critical.

This kit provides 2 3/8” of overall available depth adjustment (all shims in versus all shims out)

Due to the many different opener combinations and the wide range of adjustment on the levelling turnbuckles it may be necessary to adjust the levelling turnbuckles to get into the desired range of operation.

CORRECTIVE ACTION:

- Install the retrofit kit as per the instructions on page 2

Part Number	Description	Dealer Cost	List Price
9240-75	5810 QDA Depth Control Retrofit	\$	\$

Please contact your local Bourgault dealer for additional information and clarification and pricing and availability of parts

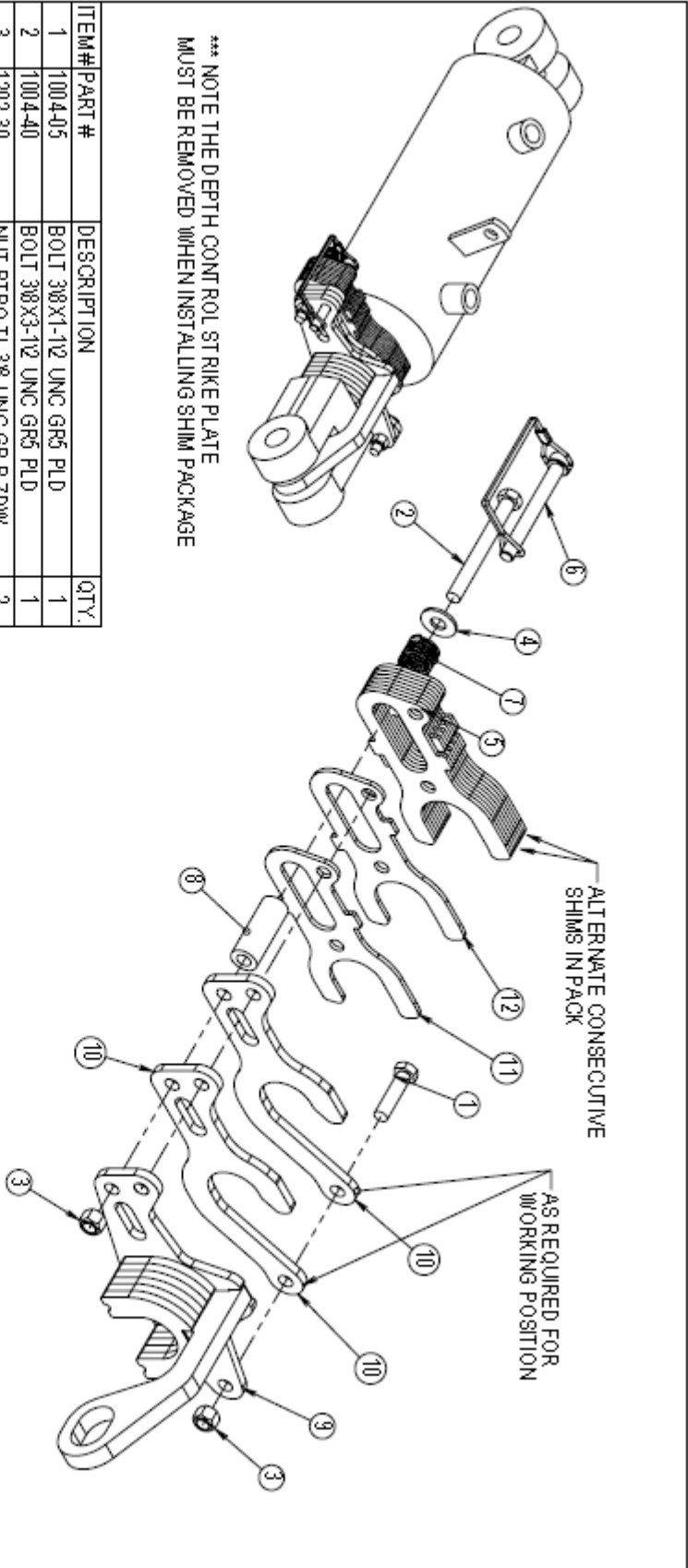

ITEM#	PART #	DESCRIPTION	QTY.
1	1004-05	BOLT 3/8X1-1/2 UNC GR5 PLD	1
2	1004-40	BOLT 3/8X3-1/2 UNC GR5 PLD	1
3	1202-30	NUT PTRQ TL 3/8 UNC GR B ZDW	2
4	1325-15	W/SHR 3/8 PL PLD	1
5	1325-39	W/SHR 3/4 SAE PLD	1
6	1600-56	PIN LK 3/8X3 PLD	1
7	2050-16	SPRING, COMPRESSION, 7/8 X 2	1
8	4161-19	BSHG 3/4 ODX1382 ODX2	1
9	9240-76	CYL CLV STOP 5810 52K2	1
10	9240-77-01	1/4 FIXED SHIM 5810 PAINTED	2
11	9240-78-01	5810 SHIM SLIDE A	5
12	9240-79-01	5810 SHIM SLIDE B	5

*** THIS PACKAGE CONTAINS ITEMS TO CREATE TWO SHIM ASSEMBLIES ***

TOLERANCES UNLESS OTHERWISE SPECIFIED:		BOURGAULT INDUSTRIES LTD.	
ANGLES ± 1° FR ACTIONS ± 1/16"		ST. BREV. 5810-76/77/78/79	
DECIMALS FRACTIONAL HOLES:		CYL SHIM ASSY 5810 52K2	
XX ± .01"	A: +0.020" -0.010"	DATE	03-NOV-20
.XXX ± .005"	B: +0.150" -0.010"	DRNBY	DML
		SCALE	1:4
		WEIGHT	8 LB
INFORMATION CONTAINED IN THIS BOOKLET IS THE SOLE PROPERTY OF BOURGAULT INDUSTRIES LTD. USE IS RESTRICTED TO THE PURPOSES FOR WHICH THE INFORMATION HAS BEEN PROVIDED. ANY REPRODUCTION OR DISTRIBUTION TO THIRD PARTIES, IN WHOLE OR IN PART, WITHOUT THE WRITTEN PERMISSION OF BOURGAULT INDUSTRIES LTD. IS PROHIBITED.		DOCUMENT NO.	9240-75
		PURPOSE	A
		COLOR	NONE