



TO: All Bourgault Dealers
ATTN: Service Manager, Parts Manager, Sales Manager
SUBJECT: XTC Depth Adjustment Upgrade

SPECIAL PRICING UPGRADE: (Failure Code 2.17)
Effective serial number range: XTC units prior to model year 2017

BACKGROUND:

The current XTC drill depth adjustment mechanism consists of a spring loaded depth adjustment handle and meshing teeth to provide 1/4" depth increments. This design has presented manufacturing challenges as well it requires customer maintenance to ensure the depth adjustment handle pivot bolt is kept at the correct tension to avoid "pre-mature" wear of the meshing teeth.

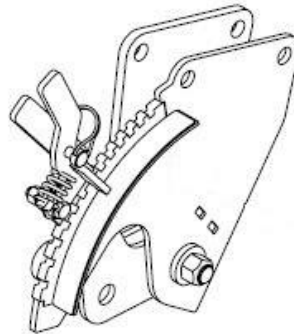

CURRENT XTC DEPTH ADJUSTMENT ASSEMBLY

With model year 2017 all XTC units will be built with a new style of depth adjustment. The meshing teeth will be replaced by a cast assembly with holes placed at specific intervals to provide 1/4" depth adjustment and the spring loaded depth adjustment handle will be replaced with a depth adjustment pin. Testing has shown this new design, with significantly more bearing area, will provide many years of use without any significant wear.

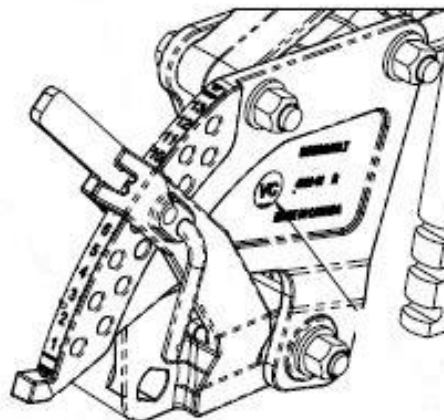

NEW STYLE XTC DEPTH ADJUSTMENT ASSEMBLY



New style retrofit kits have been developed to allow existing XTC drills to be upgraded to the new style of depth adjustment.

CORRECTIVE ACTION:

- Notify your staff involved with the Bourgault product line and your XTC customers of this available upgrade.

Part Number	Description	Special Ref Price	Special List Price	Normal Ref Price	Normal List Price
9325-80	XTC Depth Adjustment Upgrade - left				
9325-81	XTC Depth Adjustment Upgrade - right				

These kits can be ordered from the Bourgault Parts Department.

WARRANTY DETAIL: CONTACT DEALER FOR PRICING

- Warranty does not apply as “Special Pricing” is in effect
- Customers will be responsible for installation
- Customers are responsible to verify seed depth “calibration” of the updated openers to ensure consistent seeding depth between openers (page 5)
- As this is a long lead time item customers are encouraged to place orders prior to December 23, 2016 to guarantee delivery prior to the 2017 seeding season.
- Notice that “Special Pricing” is for a limited time and can change without notice.

If you have any questions regarding this TSB, please contact your Customer Service Representative



NOTE: REFER TO OPERATORS MANUAL FOR PROPER PROCEDURE ON CALIBRATING XTC OPENER AFTER INSTALLING NEW DEPTH ADJUSTMENT

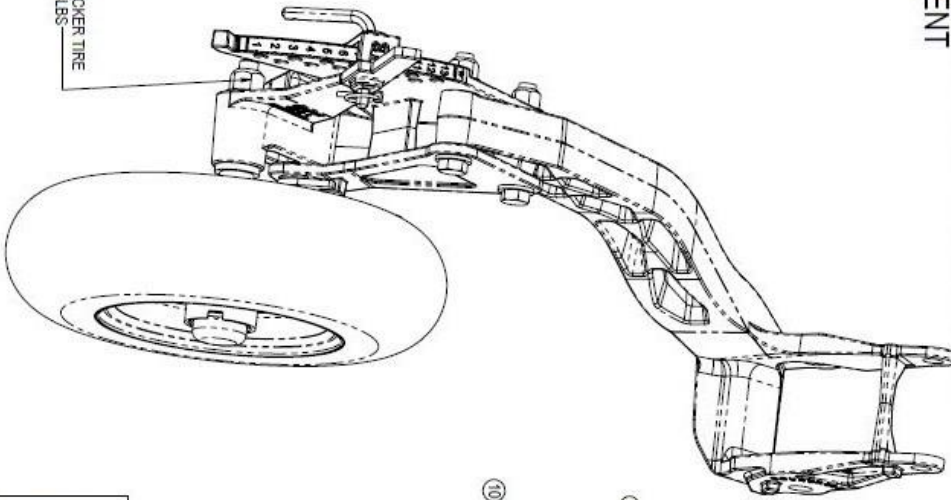

NOTE: TIGHTEN PACKER TIRE SPINDLE TO 150 FT-LBS

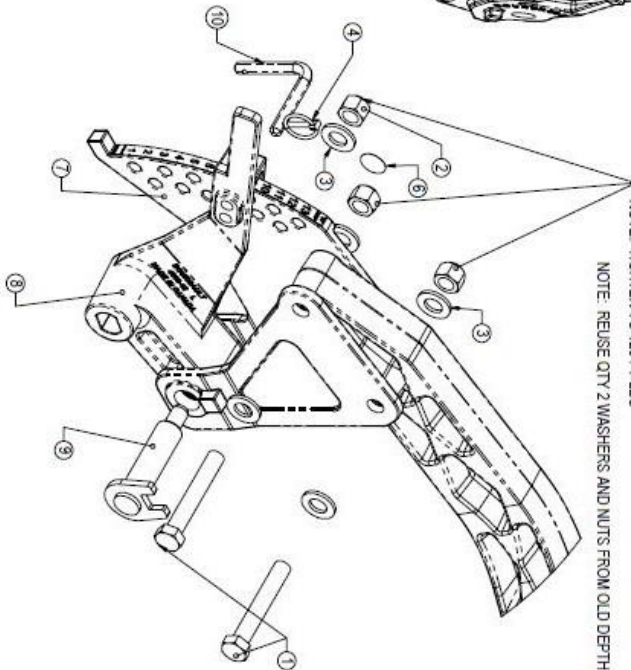

NOTE: TIGHTEN TO 120 FT-LBS
NOTE: REUSE QTY 2 WASHERS AND NUTS FROM OLD DEPTH ASSEMBLY

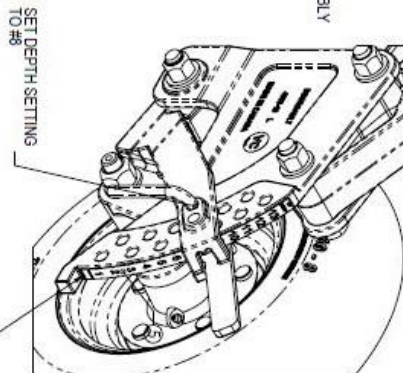

SET DEPTH SETTING TO #8
PLACE DECAL 1/16" ABOVE RADIUS ON CASTING

ITEM #	PART #	DESCRIPTION	QTY
1	1010-40	BOLT 5/8X4 UNC GR5 PLD	2
2	1206-07	NUT PTRQ TL 5/8 UNC GR B ZDW	1
3	1325-85	WSHR 5/8 HDN PLD 1.5116X .13	3
4	1600-40	CH PIN 3/16 X 1.7/16 X 1 RING	1
5	3903-98-20	DCL REAR VIEW DEP ADJ LYTC	1
6	3904-00-03	DCL VERSION LEVEL VC	1
7	9323-60-70	MFG PHTM XTC DEP ADJ LEFT	1
8	9323-62-70	MFG PHTM XTC DEP ADJ HDL LEFT	1
9	9323-64-70	MFG PHTM PIN YX3-1332 SHDR	1
10	9323-65-10	PIN DEP ADJ XTC PLD	1

FOR REVISIONS, ANGLES, DIMENSIONS, AND WEIGHTS:

ANGLES: $\pm 1^\circ$ FRACTIONS: $\pm 1/16"$
 DIMENSIONS: FRACTIONS: $\pm 1/16"$
 DECIMALS: FRACTIONS: $\pm 0.005"$
 DECIMALS: $\pm 0.01"$
 DECIMALS: $\pm 0.005"$
 DECIMALS: $\pm 0.01"$

REV | **DATE** | **DESCRIPTION** | **BY** | **CHK** | **APP** | **DATE** | **DESCRIPTION** | **BY** | **CHK** | **APP**

1 | 17-Aug-16 | REDESIGNED 3904-00-03 VERSION "C" DECAL | | | | | | | | | |

0 | 28-Jun-16 | COMPLETED DRAWINGS | | | | | | | | | |

THE INFORMATION CONTAINED IN THIS DOCUMENT IS THE SOLE PROPERTY OF BOURGAULT INDUSTRIES LTD. USE SHALL BE LIMITED TO THE EXTENT SPECIFIED IN THE DRAWINGS AND TECHNICAL SPECIFICATIONS. ANY REPRODUCTION OR TRANSMISSION OF THIS INFORMATION WITHOUT THE WRITTEN PERMISSION OF BOURGAULT INDUSTRIES LTD. IS PROHIBITED.

BOURGAULT INDUSTRIES LTD.
 51 BIRCH AVE. | GANAKA, ONTARIO | CANADA | L0R 2N0

XTC DEPTH ADJ LEFT AMK

DATE: 28-JUN-16 | DRAWN: | SCALE: 1:4 | SIZE: B | THICK: 1 OF 1
 15-528 | TRK | | | | | | | | | |

DOCUMENT NO: 9325-80 | WEIGHT: 173 LB | COLOR: NONE



NOTE: REFER TO OPERATORS MANUAL FOR PROPER PROCEDURE ON CALIBRATING XTC OPENER AFTER INSTALLING NEW DEPTH ADJUSTMENT

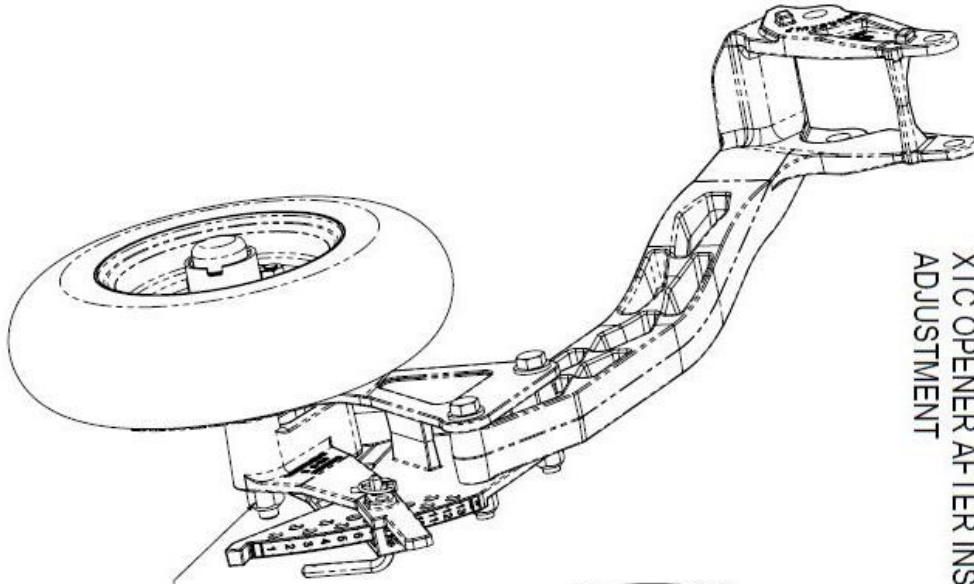

NOTE: TIGHTEN PACKER TIRE SPINDLE TO 150 FT-LBS

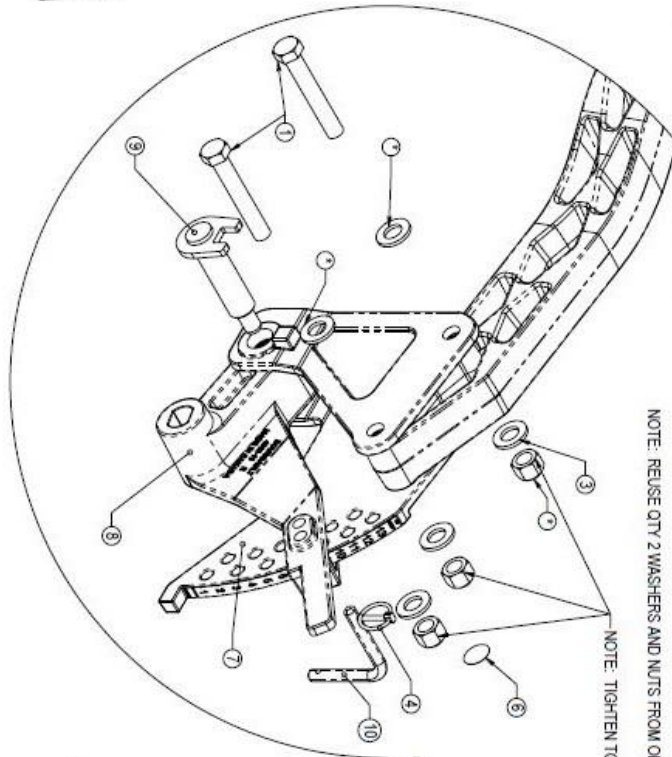

NOTE: REUSE QTY 2 WASHERS AND NUTS FROM OLD DEPTH ASSEMBLY
NOTE: TIGHTEN TO 120 FT.LBS

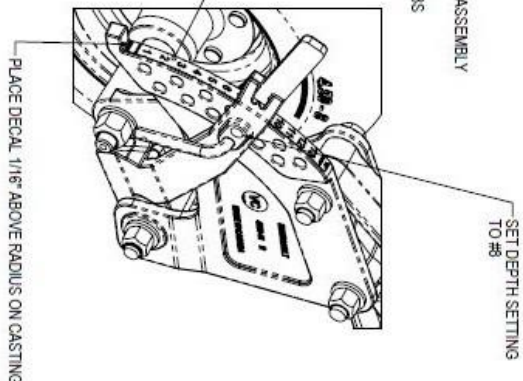

FOR PARTS AND SERVICE INFORMATION

ANGLES ± 1° FRACTIONS ± 1/16"
DECIMALS: .001
FRACTIONAL HOLES:
A: -0.0007" -0.0107"
B: -0.1507" -0.0107"
C: 0.0007" -0.0107"
D: -0.1507" -0.0107"

REV	DATE	DESCRIPTION
1	17-Aug-16	ISSUED 3804-00-03 VERSION "C" DECAL
0	25-Jun-15	COMPLETED DRAWINGS

ALL DIMENSIONS UNLESS OTHERWISE SPECIFIED ARE IN INCHES. DIMENSIONS IN PARENTHESES ARE FOR REFERENCE ONLY. DIMENSIONS IN PARENTHESES ARE FOR REFERENCE ONLY. DIMENSIONS IN PARENTHESES ARE FOR REFERENCE ONLY. DIMENSIONS IN PARENTHESES ARE FOR REFERENCE ONLY.

ITEM #	PART #	DESCRIPTION	QTY
1	1010-40	BOLT S8X4 UNC GR5 PLD	2
2	1206-07	NUT PTRX TL S8 UNC GR B ZOW	1
3	1325-65	WSHR 5/8 HDN PLD 1.516X .13	3
4	1600-40	LCH PIN 3/16 X 1.716 X 1 RING	1
5	3903-98-20	DCL REAR VIEW DEP ADJ L XTC	1
6	3904-00-03	DCL VERSION LEVEL VC	1
7	9323-61-70	MFG PHTM XTC DEP ADJ RIGHT	1
8	9323-63-70	MFG PHTM XTC DEP ADJ HOL RIGHT	1
9	9323-64-70	MFG PHTM PIN TX3-1332 SHDR	1
10	9323-65-10	PIN DEP ADJ XTC PLD	1

BOURGAULT INDUSTRIES LTD.
517 BIRCH CREEK DRIVE, CANADA S8R 3N9

XTC DEPTH ADJ RIGHT AMK

DATE: 28-JUN-16
SCALE: 1:4
SIZE: B
PAGE: 1 OF 1
WEIGHT: 174 LB
COLOR: NONE

DOC NUMBER: 9325-81

Service & Maintenance

3320 PHD™

6.3.5.2 XTC Calibration

Follow the procedure below and refer to *Figure 6.44* to properly calibrate the opener.

1. Move the drill onto level ground.
2. Lower the openers all the way to the ground. Slightly lift the openers to remove any pressure in the opener cylinders.
 - a. The openers should move by hand now.
 - b. If this is difficult, detach one end of the opener cylinder from the assembly.
3. Ensure that the weight of the opener is being carried by the packer wheel and the opener is free off the ground.
 - a. Either block up the packer wheel so that the opener can freely rotate to the fullest position or remove the opener, leaving only the shank on the assembly.
4. With the shank in the full forward position, ensure that the bottom of the depth mechanism is $1/4"$ (+/- $1/8"$) lower than the center of the middle slot on the shank.
 - a. Adjust the height of the shank by loosening the adjustment bolts as required to attain this measurement.
5. Alternatively, with the depth adjustment blocked to a known height, so that the opener tip is off of the ground when the shank is in the full forward position, the opener tip can be measured to the ground and made consistent to the adjacent openers across the drill. Calibrating the openers against themselves is more important than having them reset to the "Factory Standard".
5. Tighten the adjustment bolts (if loosened) to 110 ft-lb (+/- 25ft-lb).
6. Final Check - This step will compensate for any other variance present.
 - a. Operate the drill in the field for about 100 feet.
 - b. Check the seeding depth behind the adjusted arm in relation to the seeding depth of the adjacent arms.
 - i. If the adjusted arm seeding depth does not match the adjacent arms, loosen the adjustment bolts and reposition the shank as required.

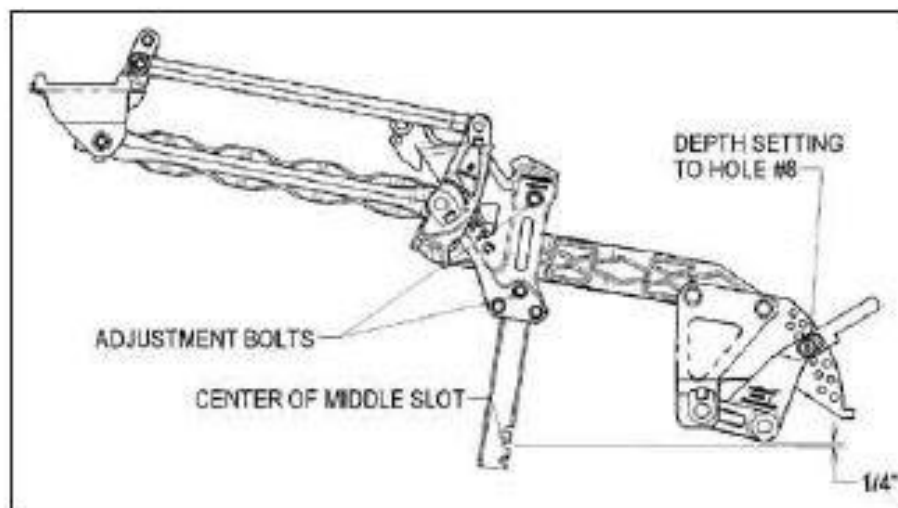

Figure 6.44 - XTC Opener Calibration